

## Instruction for installation

### Suitable gateway type (1 network port 4 serial port : 4 RS485, 1 RS232)

Gateway version: W15-1041-GW

#### 1.0 Before use the software configuration step (refer to the relevant configuration software operation manual), please confirm the following:

- the configuration project is correct;(please refer to the X2View configuration software operation instructions for details)
- upload engineering files to the touch panel;
- simulation test to collect data;

#### 2.0 Touch panel size

15.6 inch touch panel Hole size: L:384.1+3=387mm W:243.5+2.5=246mm weight: 2850g

Installation method: (Card buckle installation)

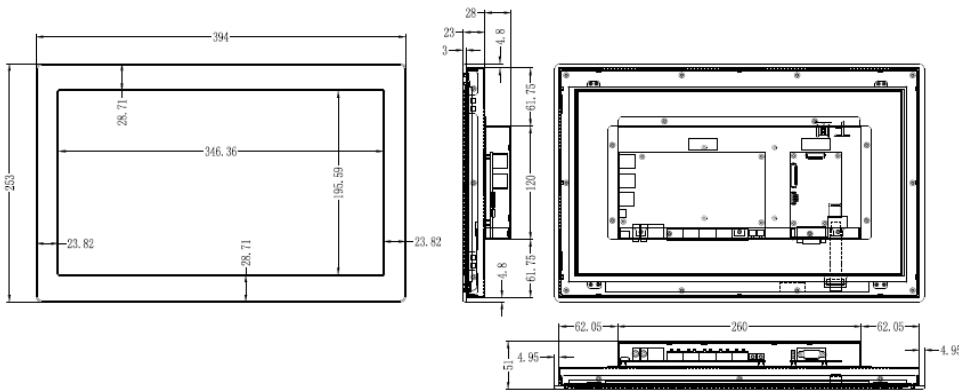

#### 3.0 wiring instructions

Power supply: AC/DC 12~24V (rated power 15W);

Network port: default IP address 192.168.1.88;

Full isolation RS485 interface: (COM1, COM2, COM3, COM4)

A positive (+) B negative (-) GND (ground)

Full isolation RS232 interface: Rx (2) TX (3) GND (5)

DB9-M: Gateway RX (2) ~~ device TX (3)

Gateway TX (3) ~~ device RX (2)

Gateway GND (5) ~~ equipment GND (5)

DB9-F: Gateway RX (2) ~~ device RX (2)

Gateway TX (3) ~~ device TX (3)

Gateway GND (5) ~~ equipment GND (5)

#### 4.0 Login touch panel Web server

Under the network cable to the Ethernet port, enter the URL on the browser:

<http://192.168.1.88/login.html>

Login Username: admin

Password: admin123456

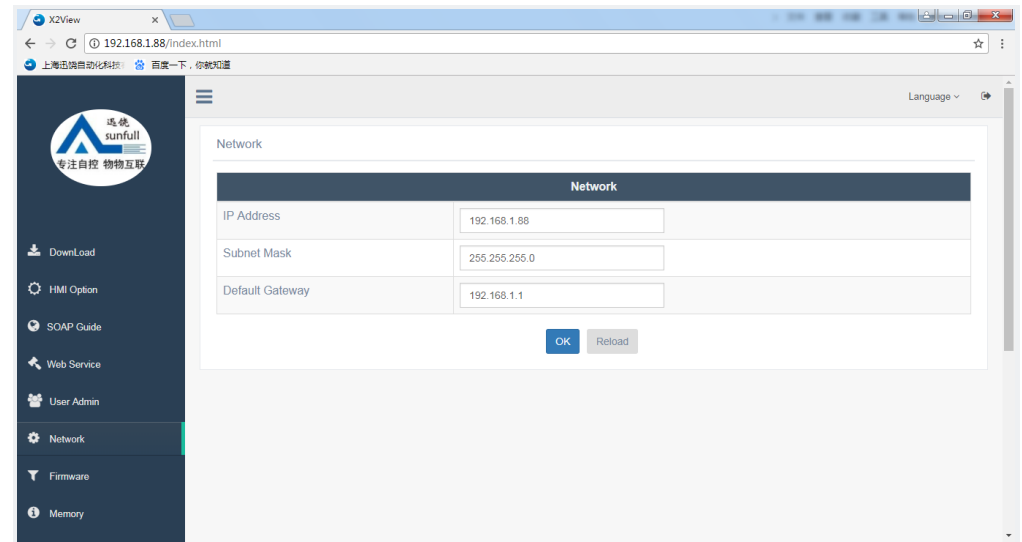

**Note: download gateway configuration software after entering the web server, please refer to the PDF document under the Help folder for specific operation.**

#### 5.0 common problems

##### Q1: how to modify the IP address of the gateway/touch panel?

**A1:** The gateway factory default IP address 192.168.1.88, subnet mask 255.255.255.0, default gateway 192.168.1.1.

For the first time using, user need a cable directly connect computer and gateway/touch panel, and then change the IP address to the computer and gateway/touch panel within the same network segment (e.g., computer IP to 192.168.1.55), after confirmation to ping, open the browser, enter the URL: <http://192.168.1.88/> login. HTML, log on to the Web server, as shown above in the " network" column set IP address.

**Q2:** What if the project files are not found in the computer?

**A2:** The project files can be downloaded in the configuration software; or login the gateway/touch panel to the WEB page "download " and click "project file" to download.

**Q3:** what is the difference between different models of the gateway hardware?

**A3:**The main models are as follows:

Model	Hardware Parameter	Interfaces	Supported Points	Supported Ports
1002-LITE	CPU: 240MHz Memory: 32M	1 ethernet 2 serial ports	256	2 RS485 & 2 RS232
1002-ARM	CPU: 240MHz Memory: 32M	1 ethernet 2 serial ports	256	2 RS485 & 2 RS232
2004-LITE	CPU: 400MHz Memory: 64M	2 ethernet 4 serial ports	1024	4 RS485
2004-ARM	CPU: 400MHz Memory: 64M	2 ethernet 4 serial ports	1024	4 RS485
2004-A9	CPU: 1.4GMHz Memory: 512M	2 ethernet 4 serial ports	2048	4 RS485
1022-1U	CPU: 400MHz Memory: DDR2	1 ethernet 4 serial ports	1024	4 RS485

#### Sunfull Gateway model

BACnet Gateway: BAC1002-LITE (economical), BAC1002-ARM, BAC2004-LITE (economical), BAC2004-ARM, BAC2004-A9

Modbus Gateway: MOD1002-LITE (economical), MOD1002-ARM, MOD2004-LITE (economical), MOD2004- ARM, MOD2004-A9

Modbus Hub Gateway: HUB1002- ARM, HUB2004-ARM

SMS Alarm Gateway: HMI2004-A9-GPRS

SNMP Gateway: SNMP1002- ARM, SNMP2004-ARM

IEC104 Gateway: IEC 2004-ARM

WEB Configuration Gateway: HMI2004-A9-GW

#### Sunfull WEB Touch Panel series

Basic version: W7-1041

Gateway version: W7-1041-GW, W10-1041-GW, W15-1041-GW

#### Sunfull Software Gateway

OPC transfer BACnet: O2B- Softkey, O2B-USBkey

OPC transfer Modbus: O2M- Softkey, O2M-USBkey

OPC transfer Modbus- cloud: O2M-WEB- Softkey, O2M-WEB-USBkey

OPC transfer IEC104: O2I-Softkey、 O2I-USBkey

OPC transfer SMS: O2S-Softkey、 O2S-USBkey

OPC transfer Web: O2W-Softkey、 O2W-USBkey

OPC transfer SNMP: OtS-Softkey、 OtS-USBkey

#### Sunfull OPC server

OPC server: X2O- Softkey, X2O-USBkey

OPC server: OPCHub

#### Sunfull Free Software

BACnetScan scanning tool, MBUS scanning tool, Niagara interface, and WEBS interface

Welcome to follow Shanghai Sunfull's wechat public number : BACnet  
to know more new products and solutions.



Shanghai Sunfull Automation Co., LTD. TEL: +86-021-58776098

Address: A466, building1, NO.2588, Jinhai Road, Pudong, Shanghai, China

Technical support E-mail: support@opcmaster.com

Technical support Tel: 021-20252795

Website 1: www.bacnetchina.com

SalesTel: 13564889340

Contacts: Linda Chen

Website 2: www.opcmaster.com